

Fields Corner Branch Library

Public Meeting #3

June 17, 2018



**BOSTON
PUBLIC
LIBRARY**

Martin J. Walsh, Mayor
Boston Public Library
City of Boston, Public Facilities Department
Oudens Ello Architecture / RODE Architects

Agenda

1. Introduction and Team

2. Schedule

3. What we presented at Meeting #2

4. Review of Proposed Library Program

- a. Library Improvements
- b. Proposed Program Summary
- c. Review of Proposed Program Spaces

5. Review of Building Massing

6. Next steps

7. Comments

8. Feedback Contact

Project Team

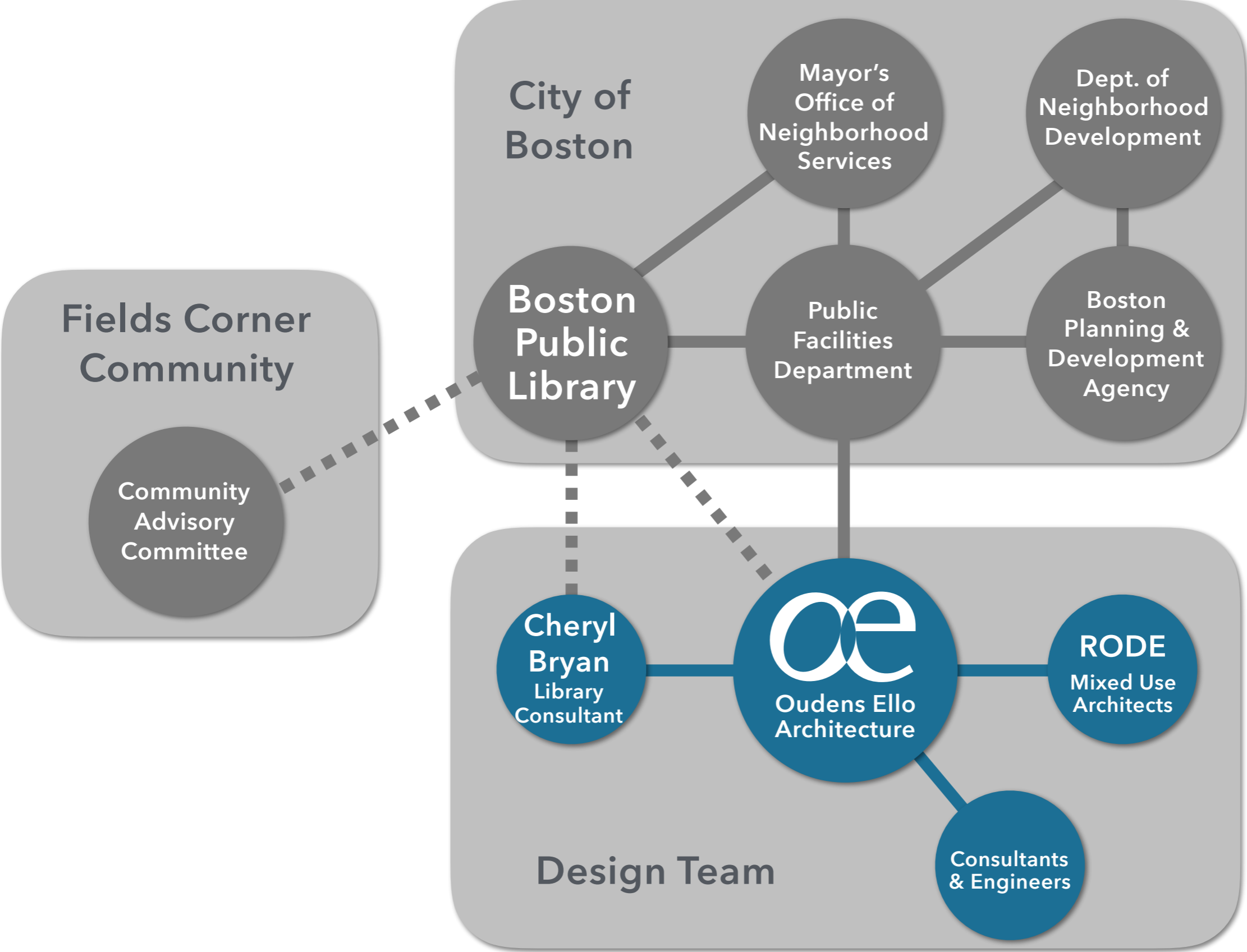

Program Study Schedule

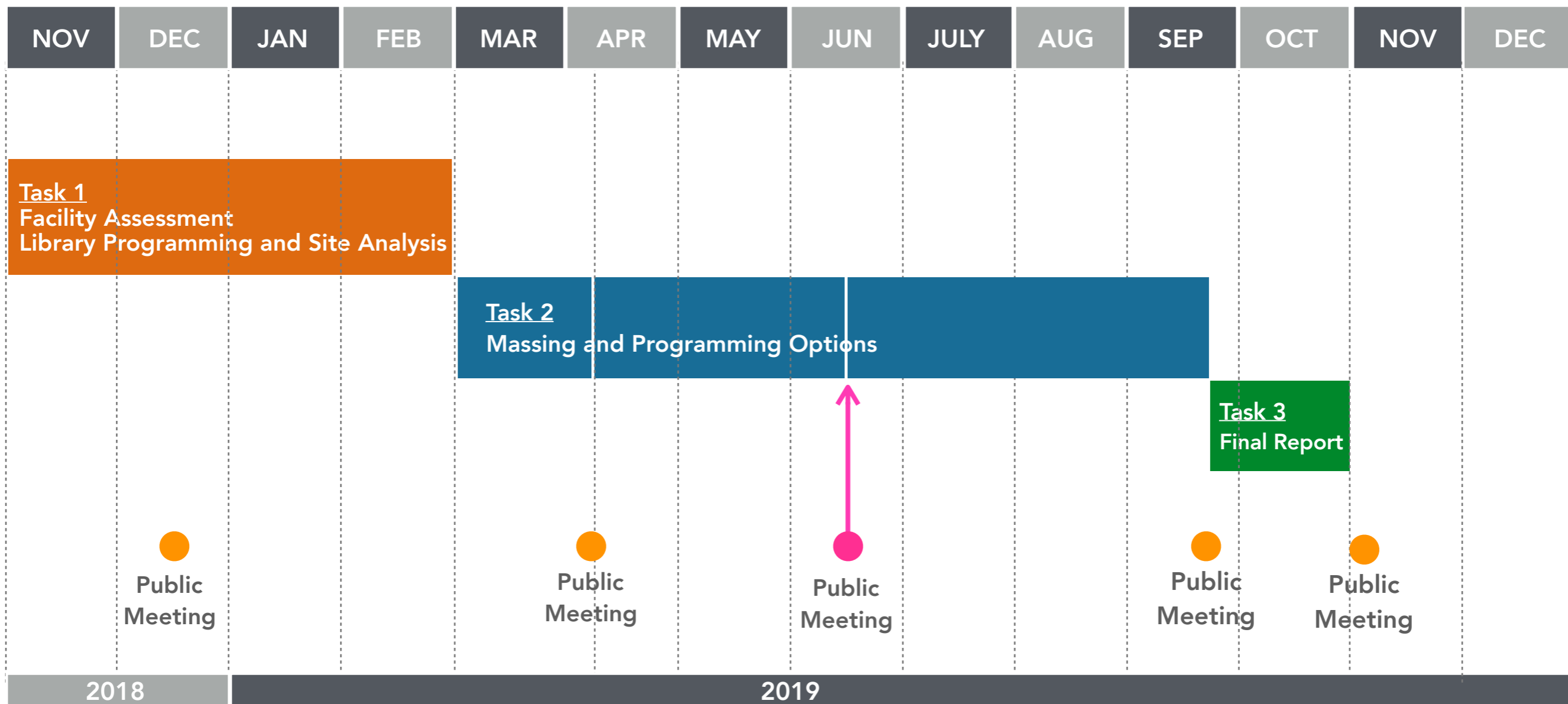

What We Heard at the Last Meeting

COMMUNITY PROCESS

Add additional Community Advisory Committee (CAC) meeting(s) so that community can advise on library programming and planning

MIXED-USE

Promote space for non-profits and/or community uses as the mixed-use component

Support for housing as mixed-use program with library

Support for a 5-story massing of mixed-use scheme

LIBRARY PROGRAM

Interest in an outdoor reading/garden space

Include bike parking

Design to accommodate use by the senior/elderly population in the neighborhood

Goals for this Meeting:

Community Input on Library Programming

What programs and activities do you want the branch to be able to accommodate?

Are there any other uses/needs/spaces that should be considered in the proposed program?

What program adjacencies or relationships are important to you?

What kinds of material would you like to see in the collection?

Library Program



Proposed Program Summary



Community Program
2,140 ft² (17%)

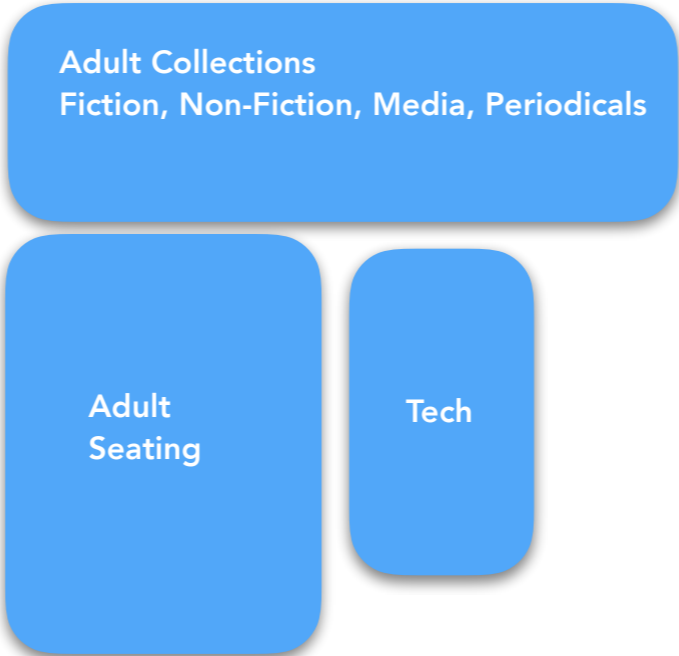

Adult
3,195 ft² (26%)



Children
2,445 ft² (20%)

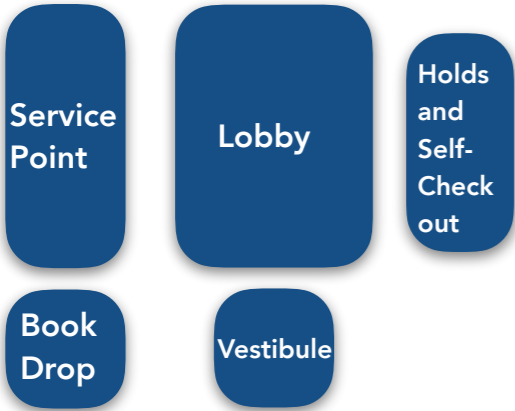

Entry
1,105 ft² (9%)



Staff
829 ft² (7%)

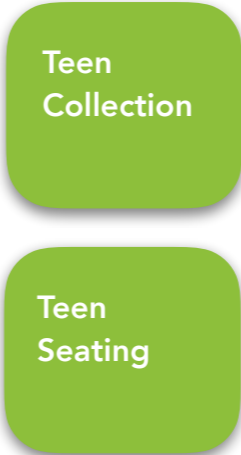

Teen
767 ft² (6%)



Service
1,790 ft² (15%)

Program Range

The final size will fall between 8,557 - 14,725 ft2

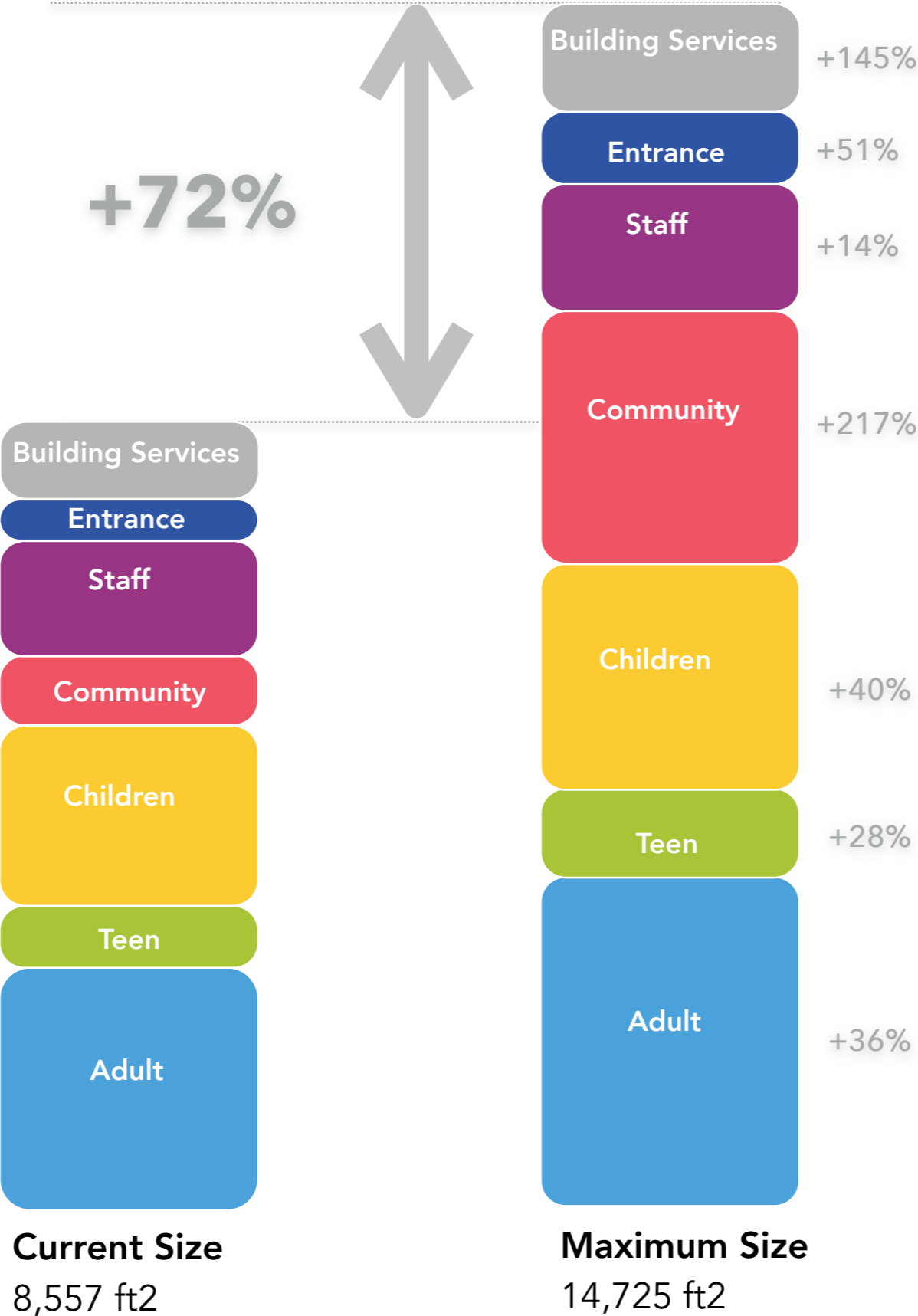

Program Range

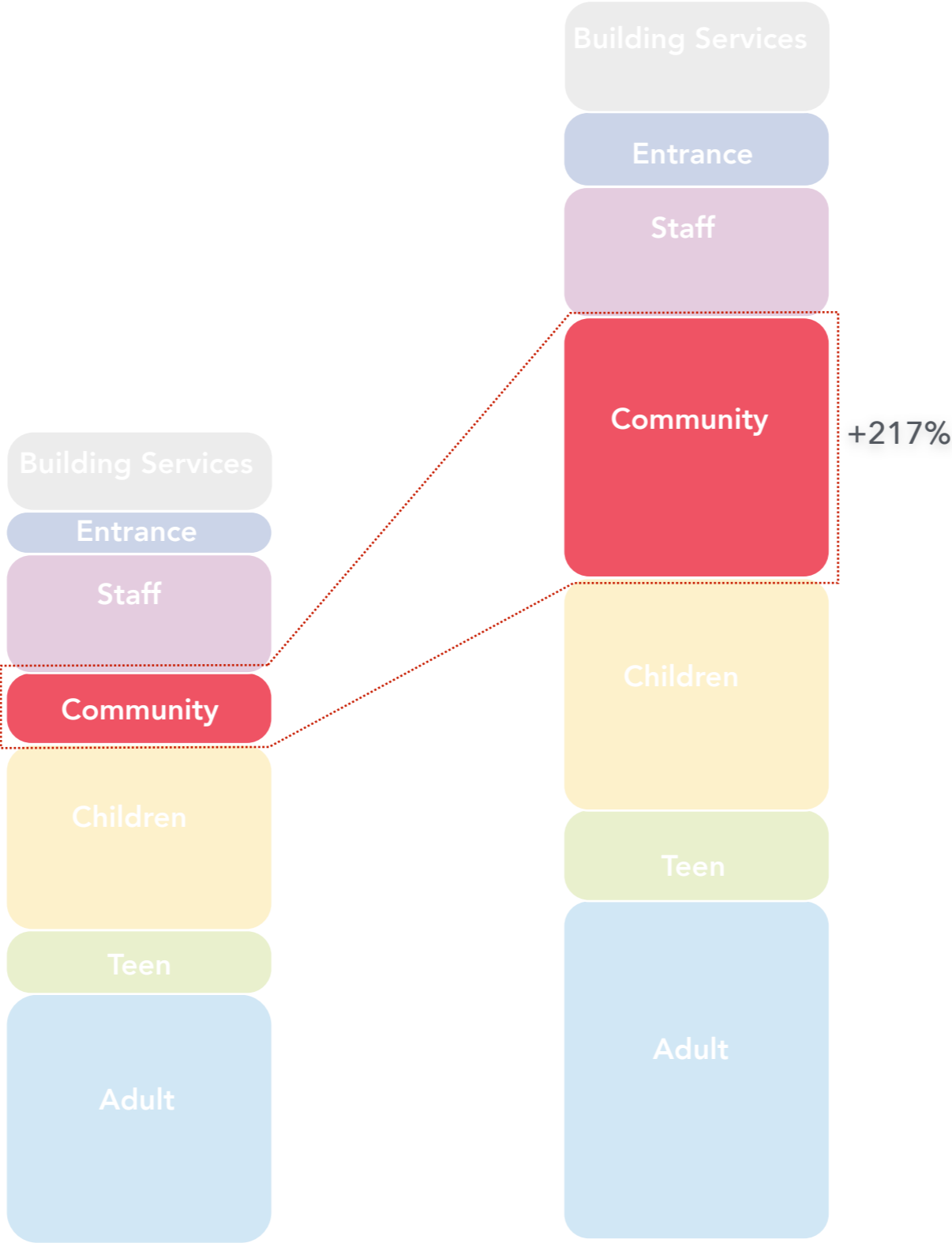

Community Existing

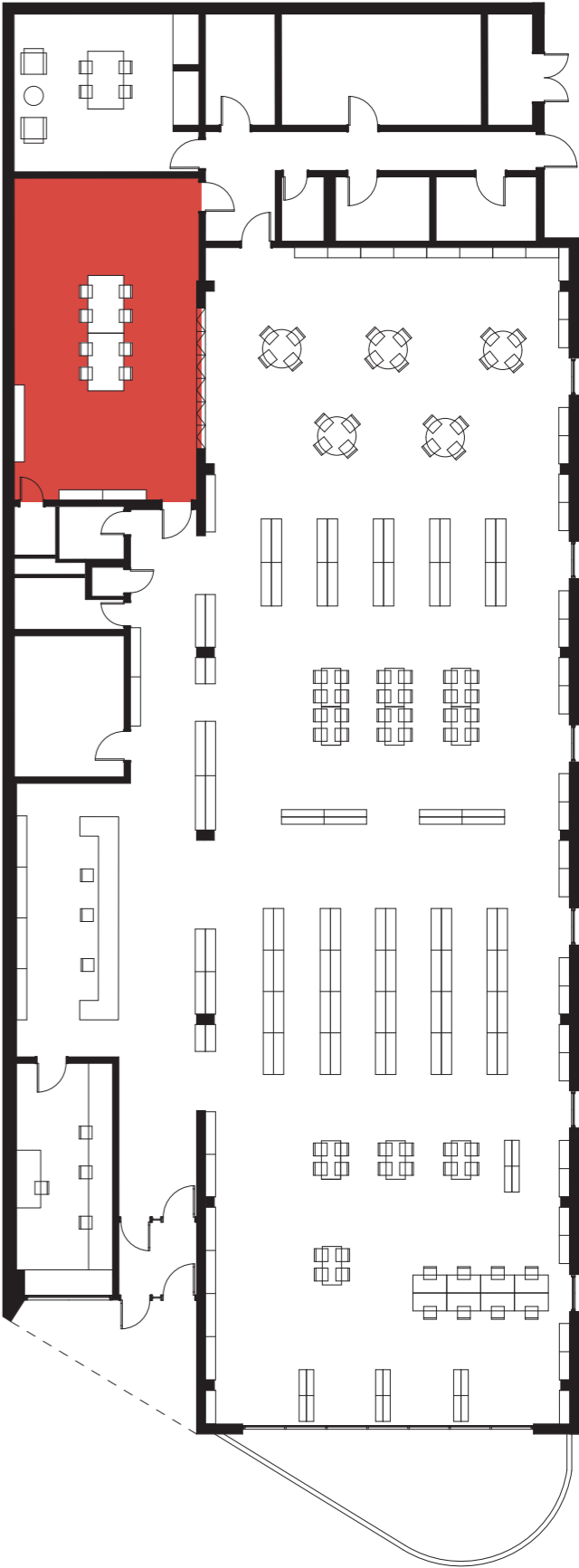

Community Proposed

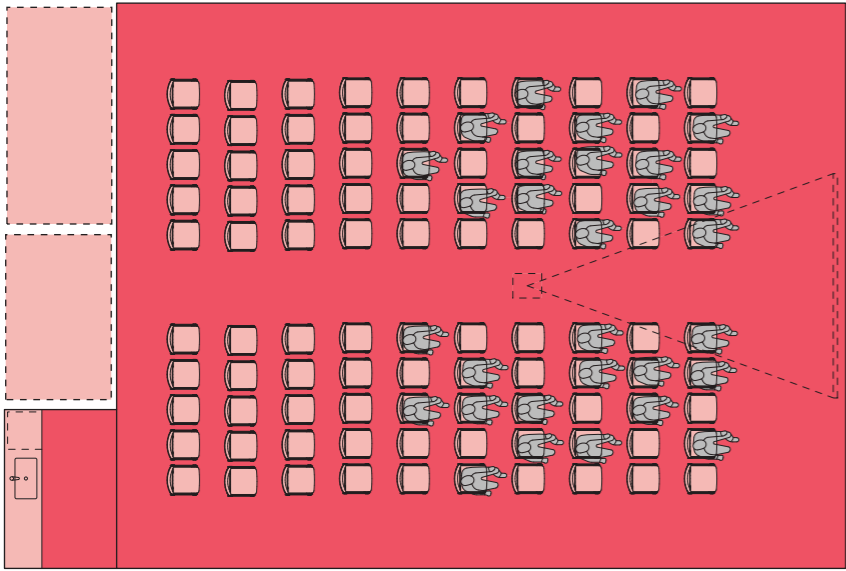

Community Room
1,100 ft² + 50 ft² Kitchenette + 150 ft² Storage

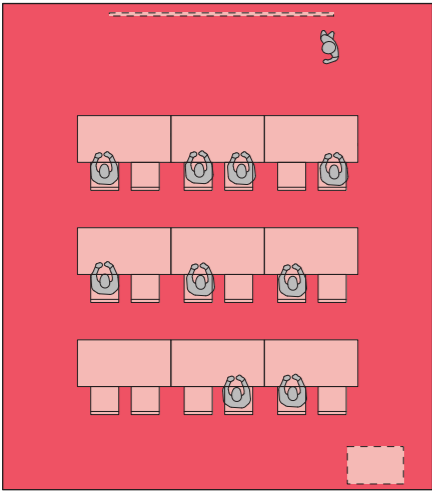

Classroom
600 ft²

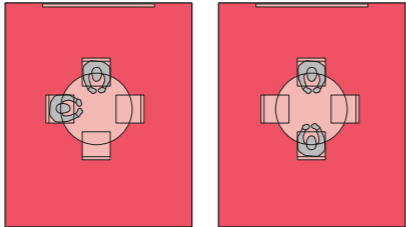

Study Rooms
120 ft² each

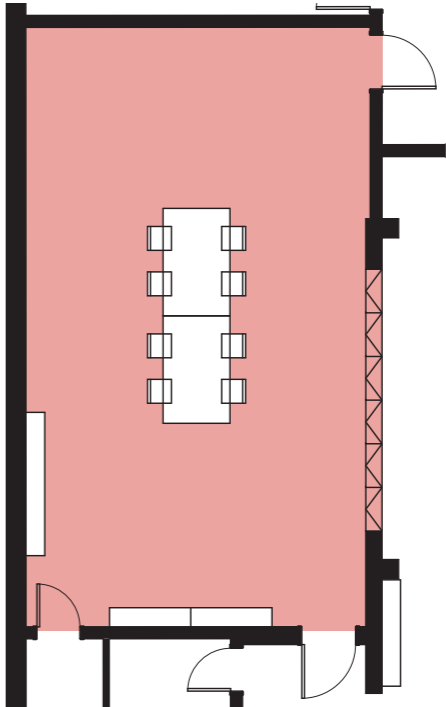

EXISTING
675 ft²

PROPOSED
2,140 ft² (217% increase)

Community Proposed

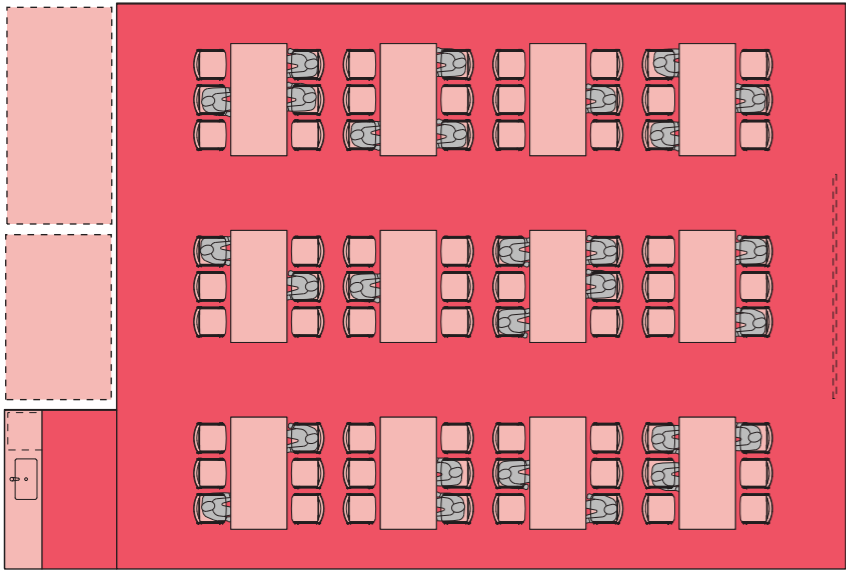

Community Room

1,100 ft² + 50 ft² Kitchenette + 150 ft² Storage

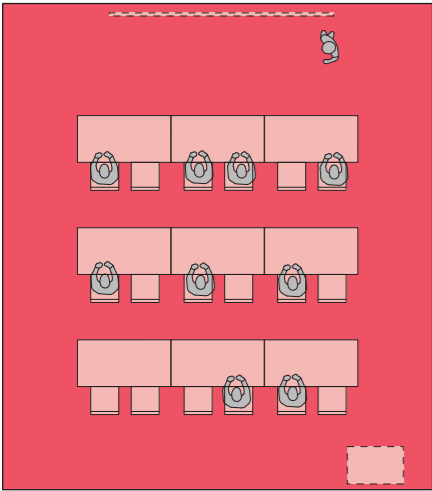

Classroom

600 ft²

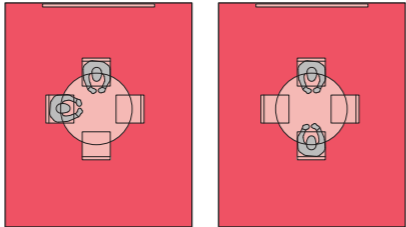

Study Rooms

120 ft² each

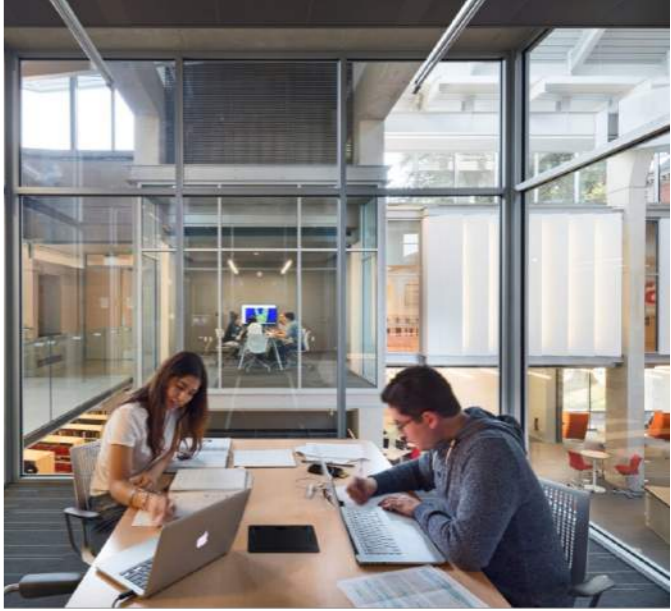

Entry Existing

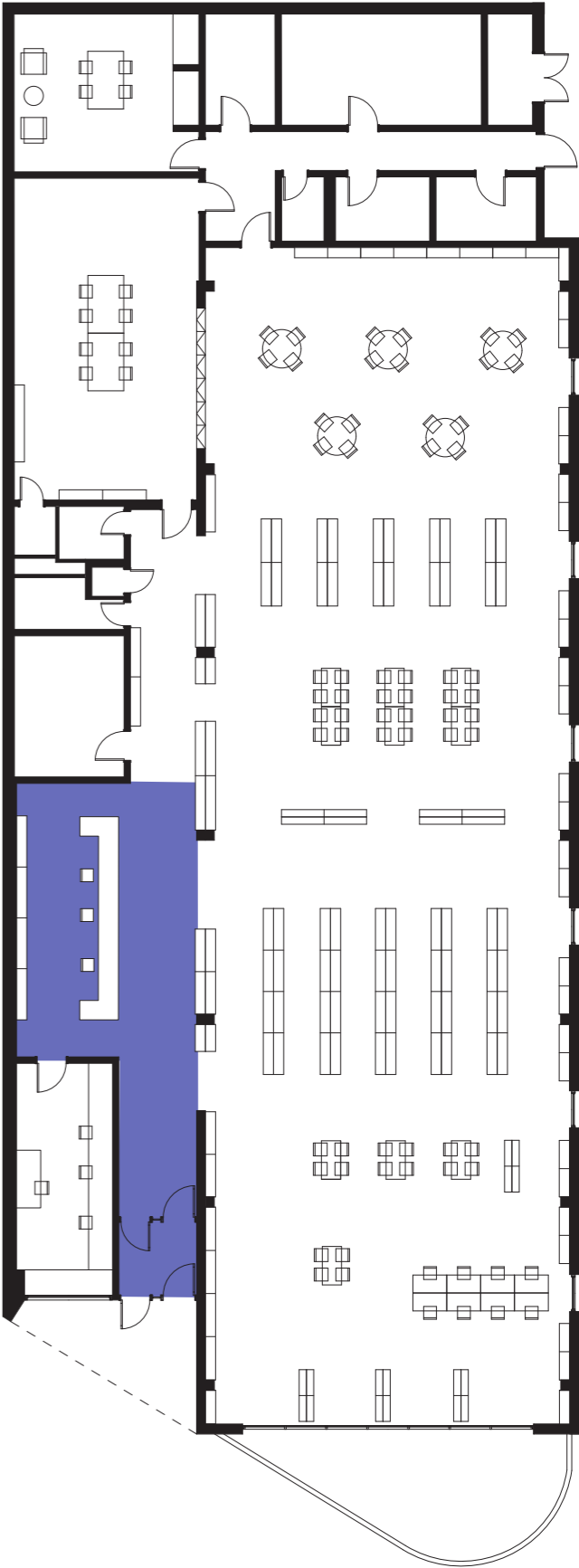

Entry Proposed

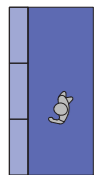

**Friends Book
Sale Shelves**
40 ft²

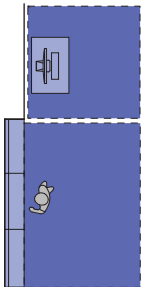

**Self Checkout
and Reserves**
150 ft²

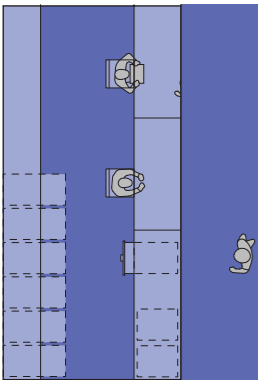

**Service
Point**
325 ft²

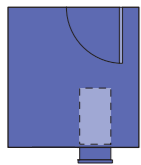

**Book
Drop**
60 ft²

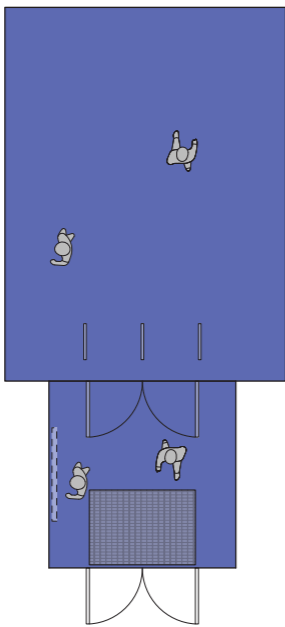

Vestibule
130 ft²

Lobby
300 ft²

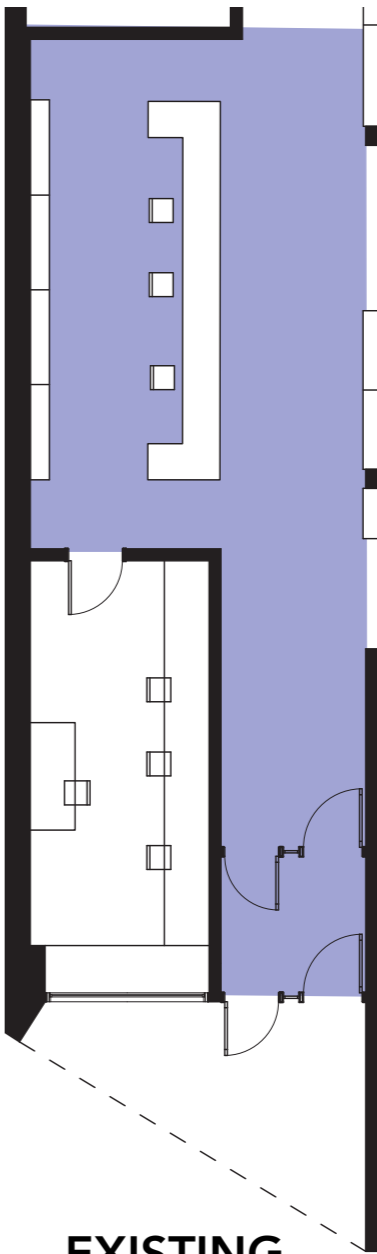

EXISTING
732 ft²

PROPOSED
1,105 ft² (51% increase)

Entry Proposed

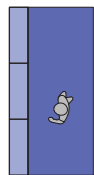

**Friends Book
Sale Shelves**
40 ft²

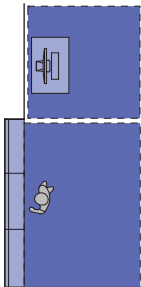

**Self Checkout
and Reserves**
150 ft²

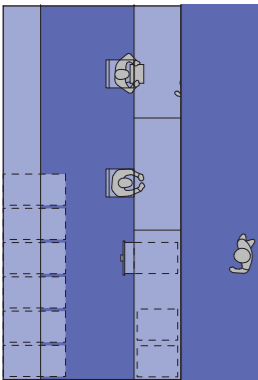

**Service
Point**
325 ft²

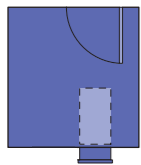

**Book
Drop**
60 ft²

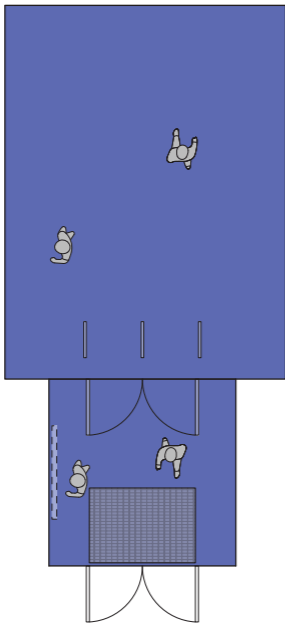

Vestibule
130 ft²

Lobby
300 ft²



Adult Existing

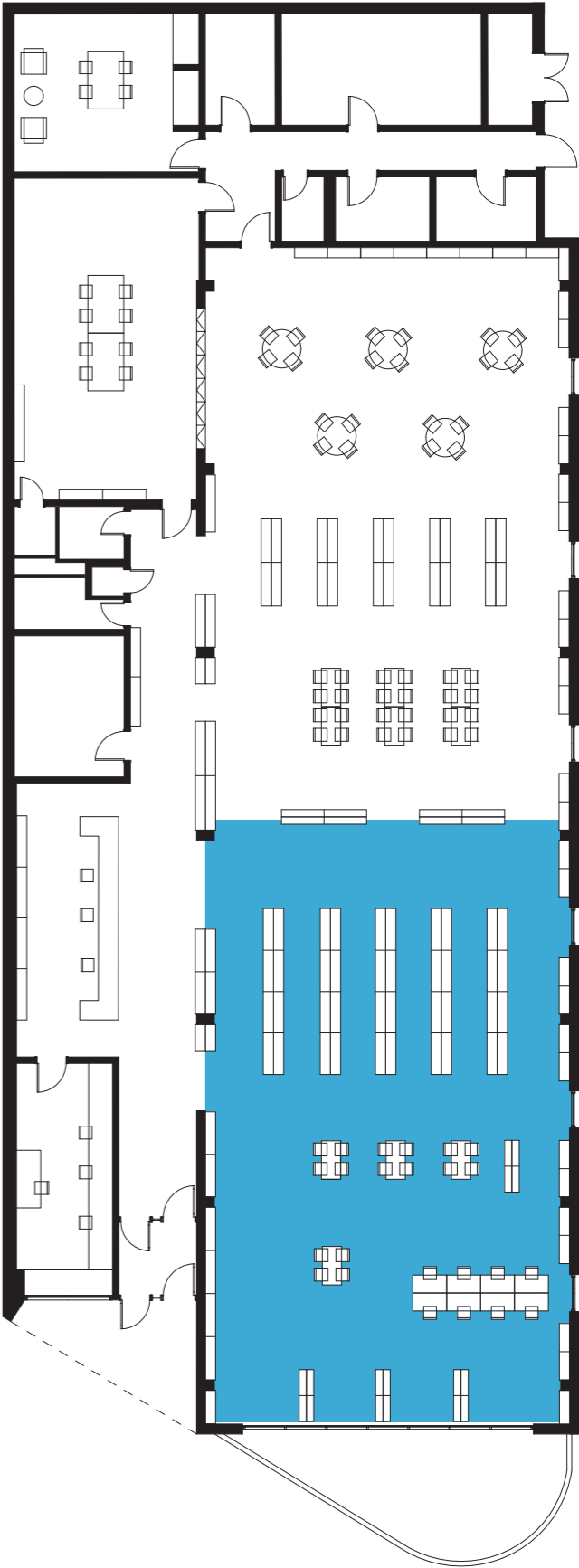

Adult Proposed

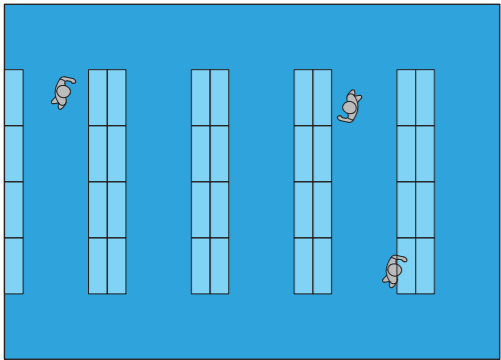

Fiction
510 ft2

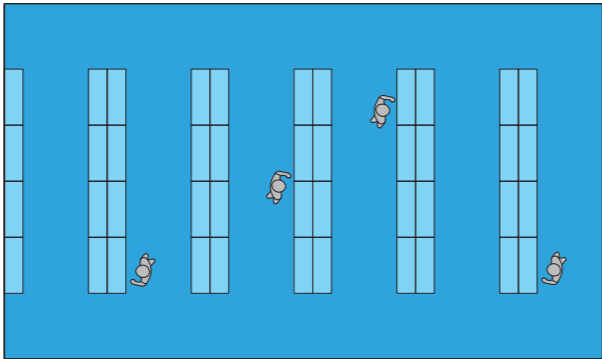

Non-Fiction
654 ft2

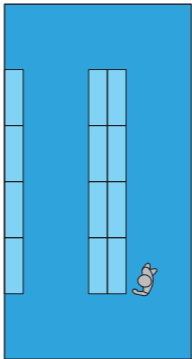

Media
250 ft2

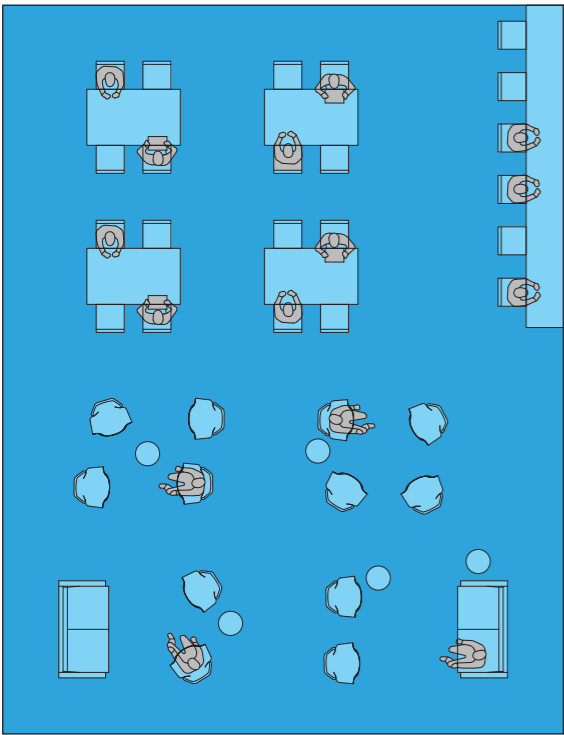

Seating
1,190 ft2

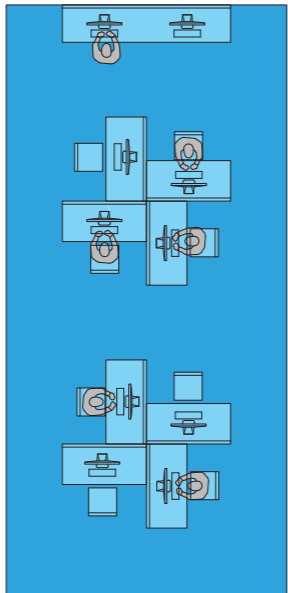

Adult Technology
450 ft2

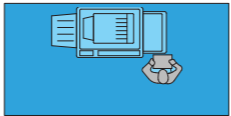

Print Release Station
50 ft2

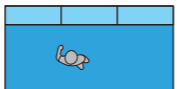

Periodicals
40 ft2



New Materials and Lucky Day
40 ft2



Immigration Materials Display
20 ft2

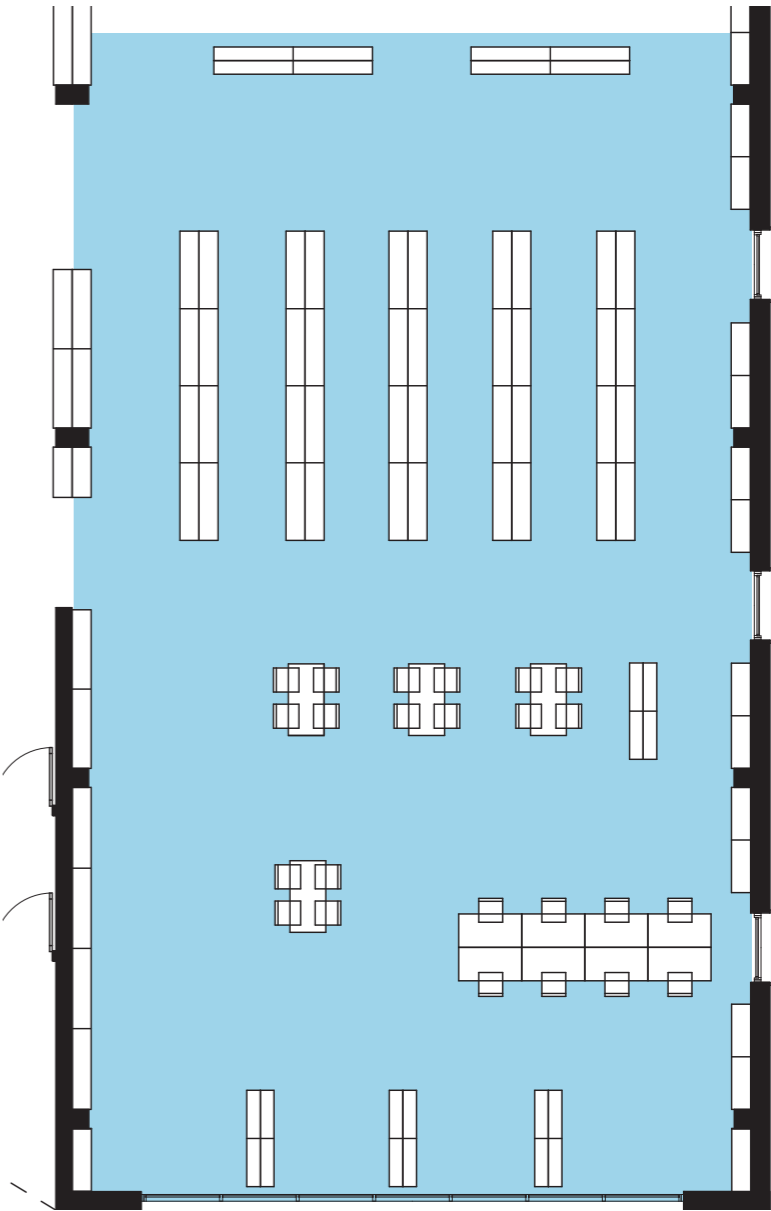

EXISTING
2,350 ft2

PROPOSED
3,195 ft2 (36% increase)

Adult Proposed

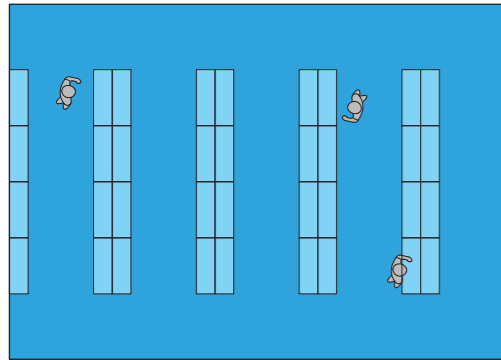

Fiction
510 ft²

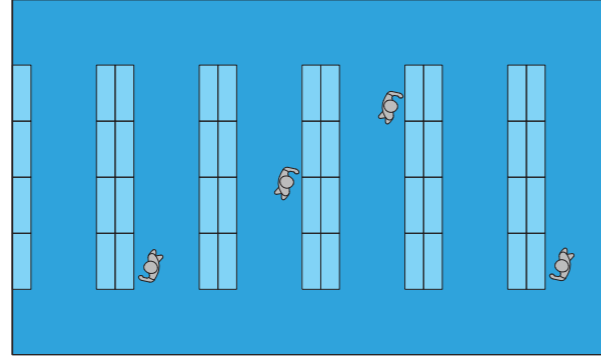

Non-Fiction
654 ft²

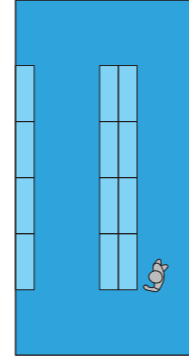

Media
250 ft²

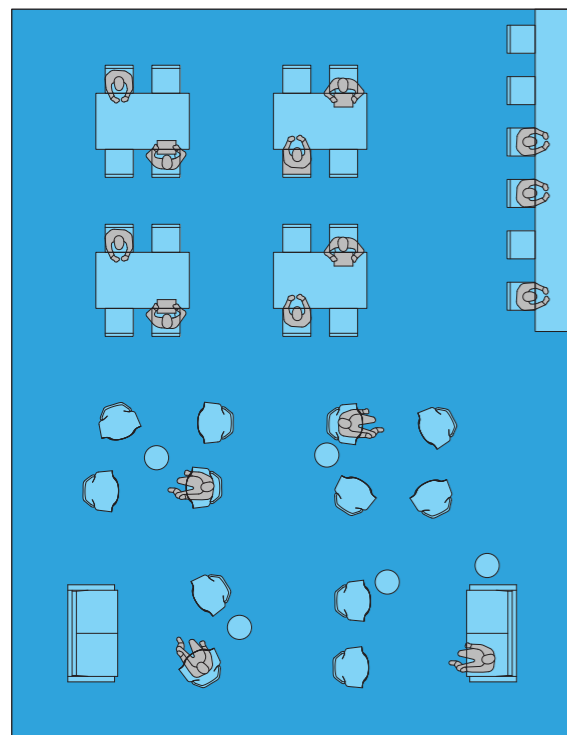

Seating
1,190 ft²

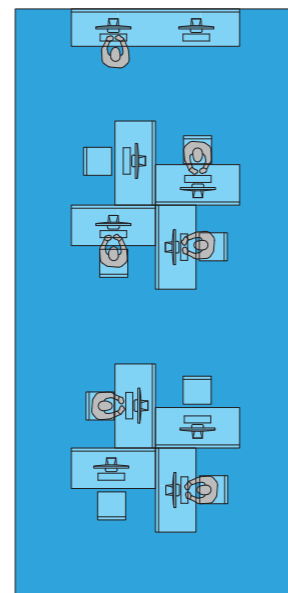

Adult Technology
450 ft²

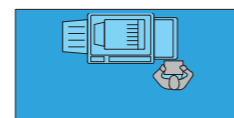

Print Release Station
50 ft²

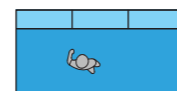

Periodicals
40 ft²

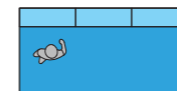

New Materials and Lucky Day
40 ft²



Immigration Materials Display
20 ft²



Childrens Existing

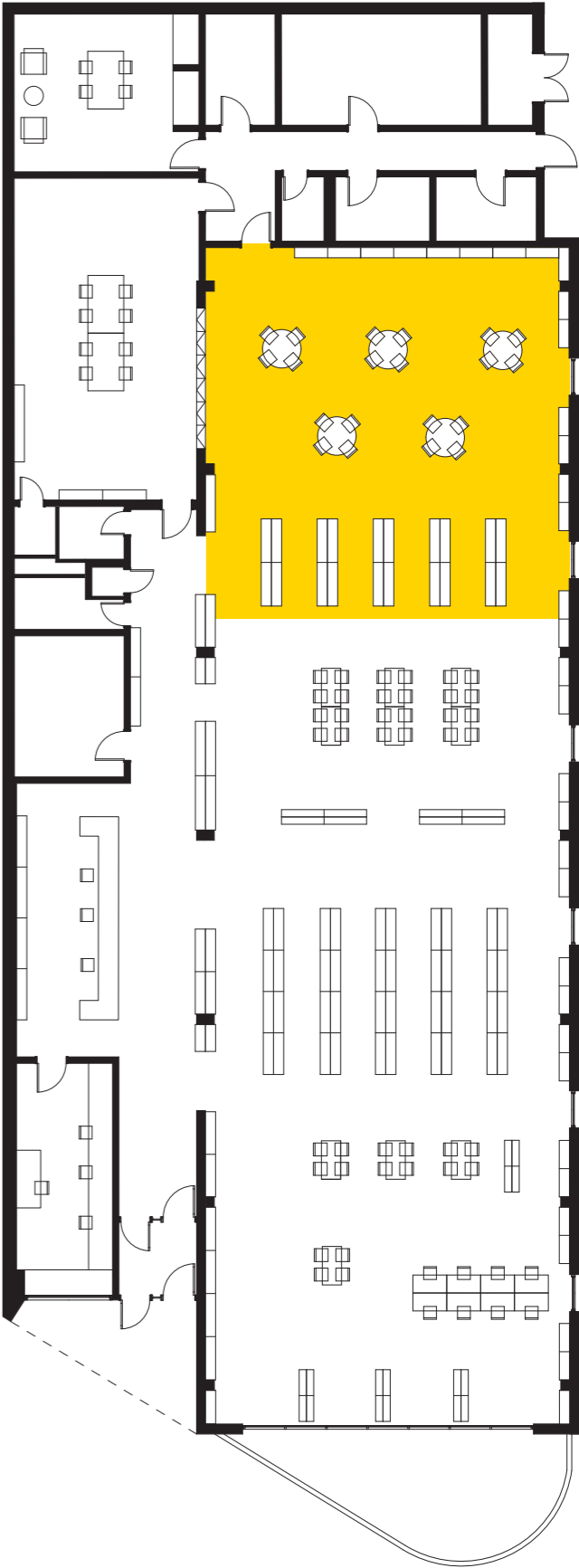

Children Proposed

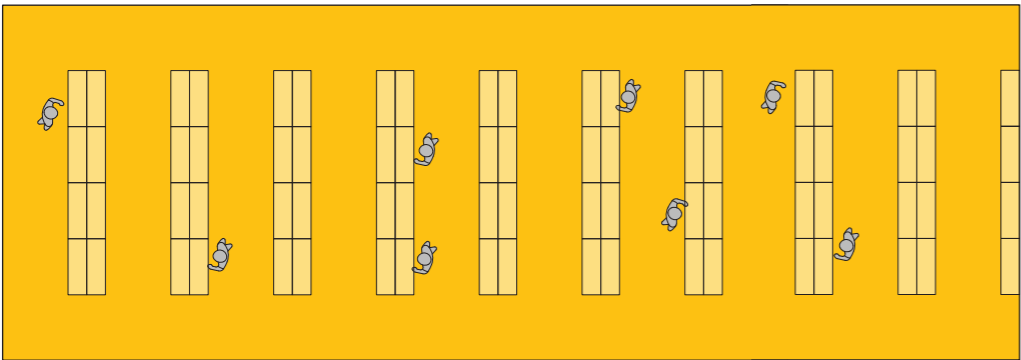

Children's Collection
1093 ft2

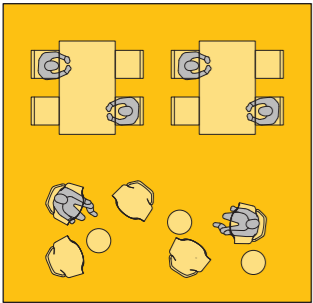

Tweens
220 ft2

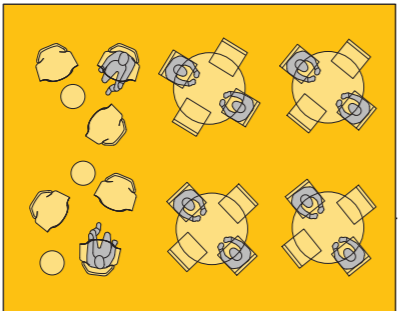

Children's Seating
330 ft2

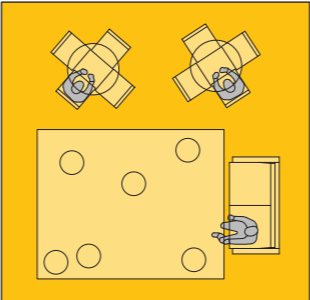

Early Literacy
220 ft2

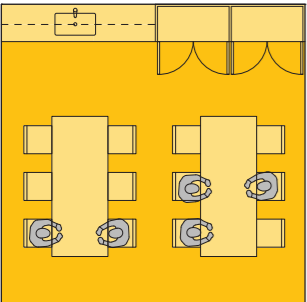

Craft Alcove
250 ft2

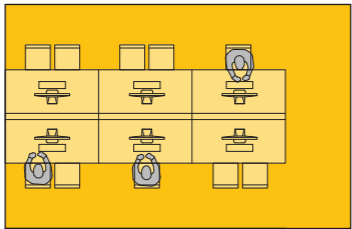

Children's Technology
225 ft2



Service Point
45 ft2

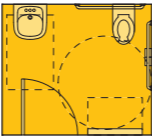

Family Restroom
60 ft2

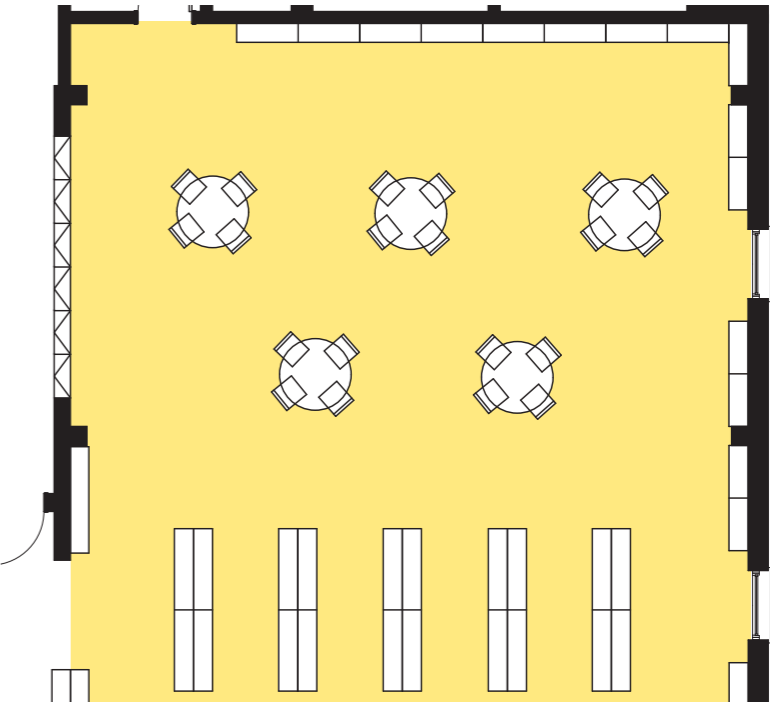

EXISTING
1,750 ft2

PROPOSED
2,445 ft2 (40% increase)

Children Proposed

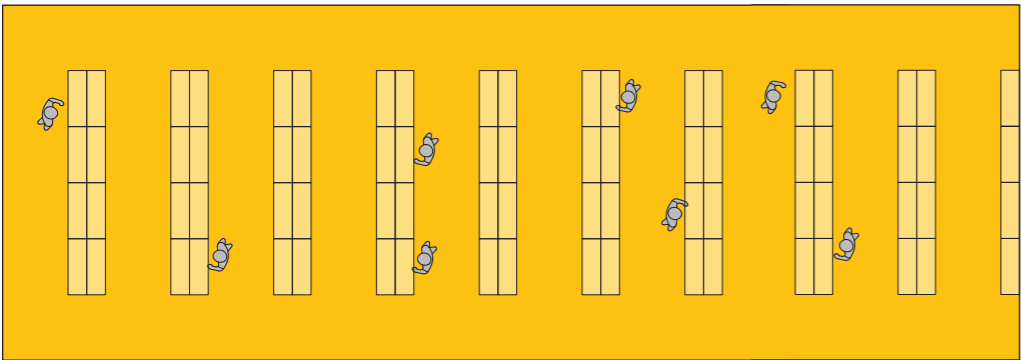

Children's Collection
1093 ft2

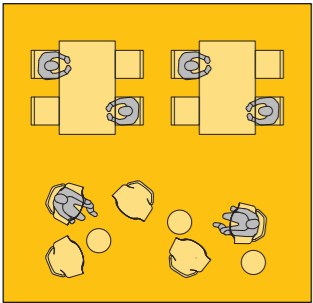

Tweens
220 ft2

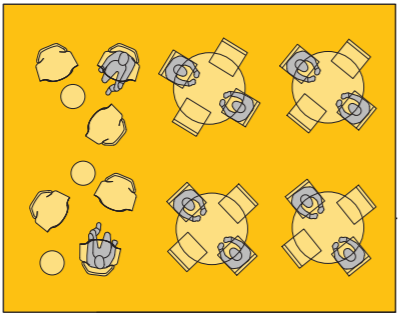

Children's Seating
330 ft2

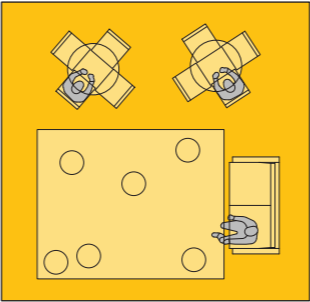

Early Literacy
220 ft2

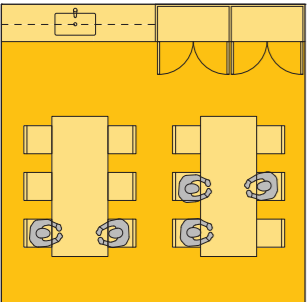

Craft Alcove
250 ft2

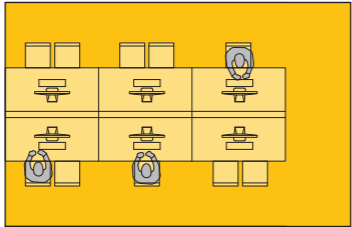

Children's Technology
225 ft2



Service Point
45 ft2

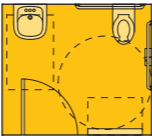

Family Restroom
60 ft2



Teen Existing

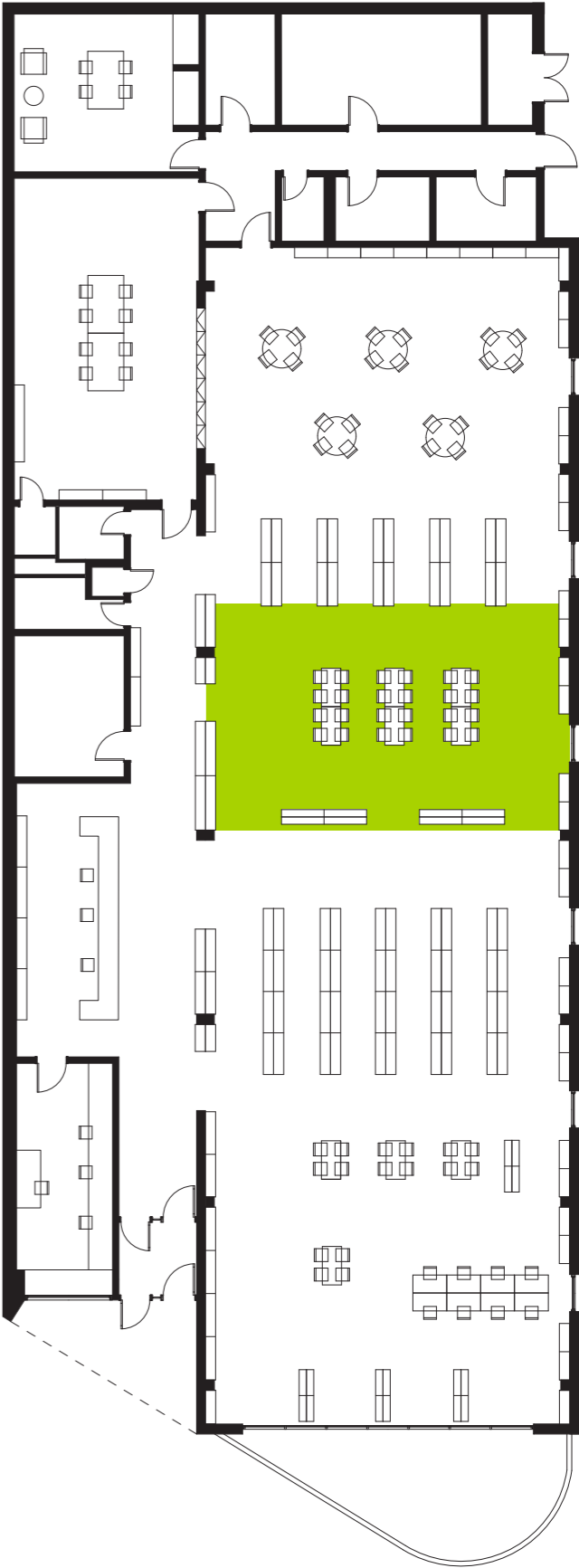

Teen Proposed

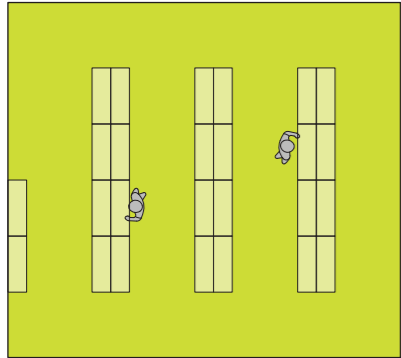

Teen Collection
385 ft²

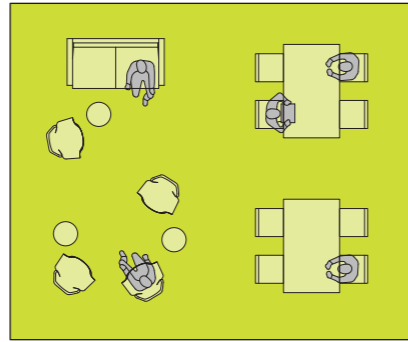

Teen Seating
382 ft²

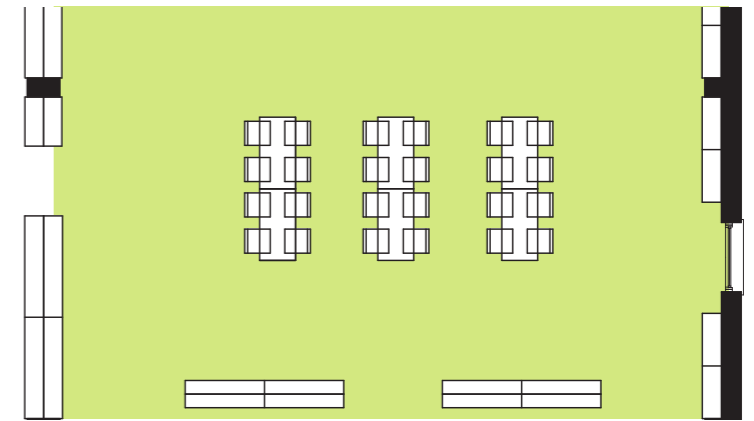

EXISTING
600 ft²



PROPOSED
767 ft² (28% increase)

Program Adjacencies

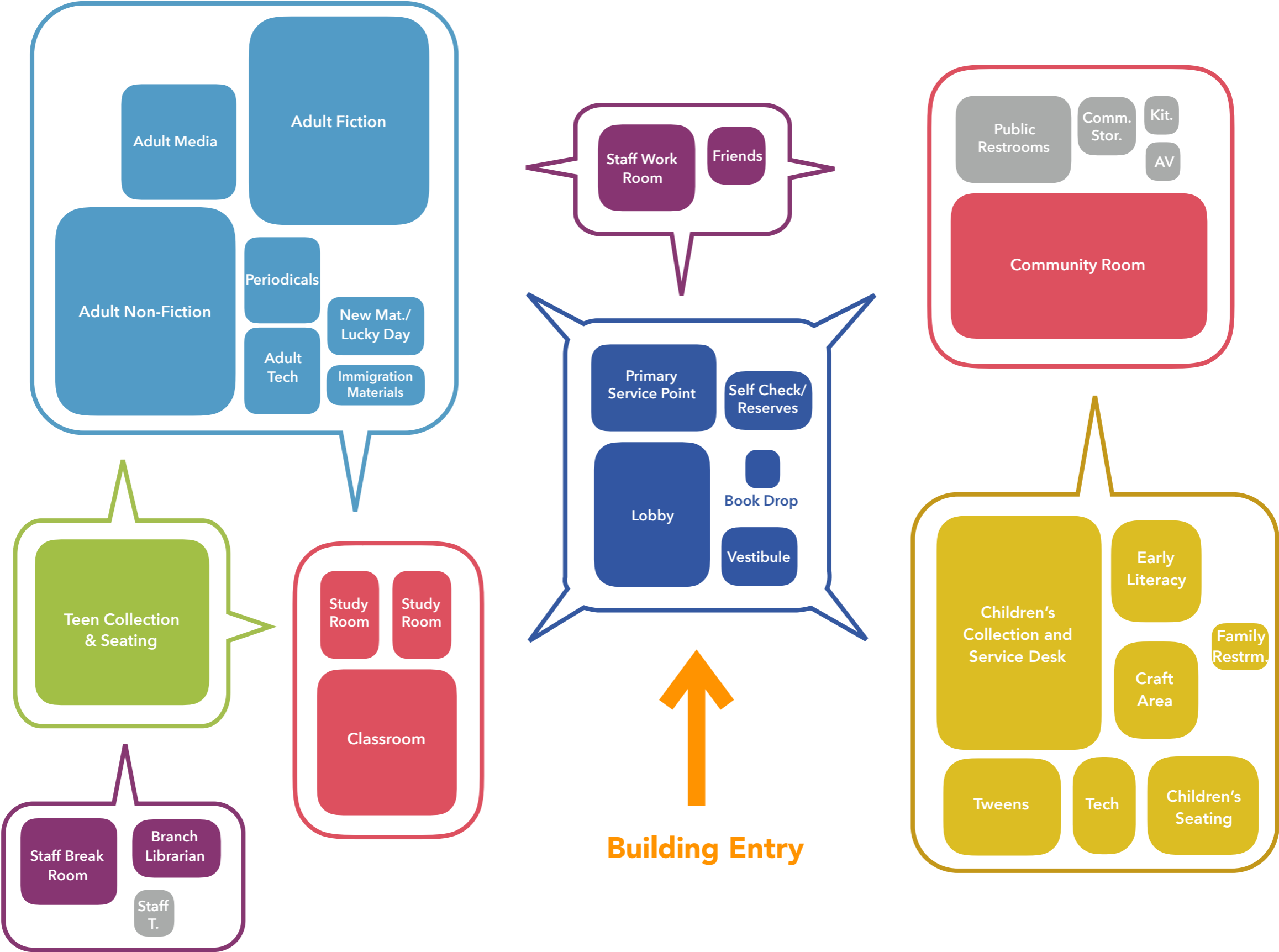

Building Massing



Existing Branch Library



Available Building Lot

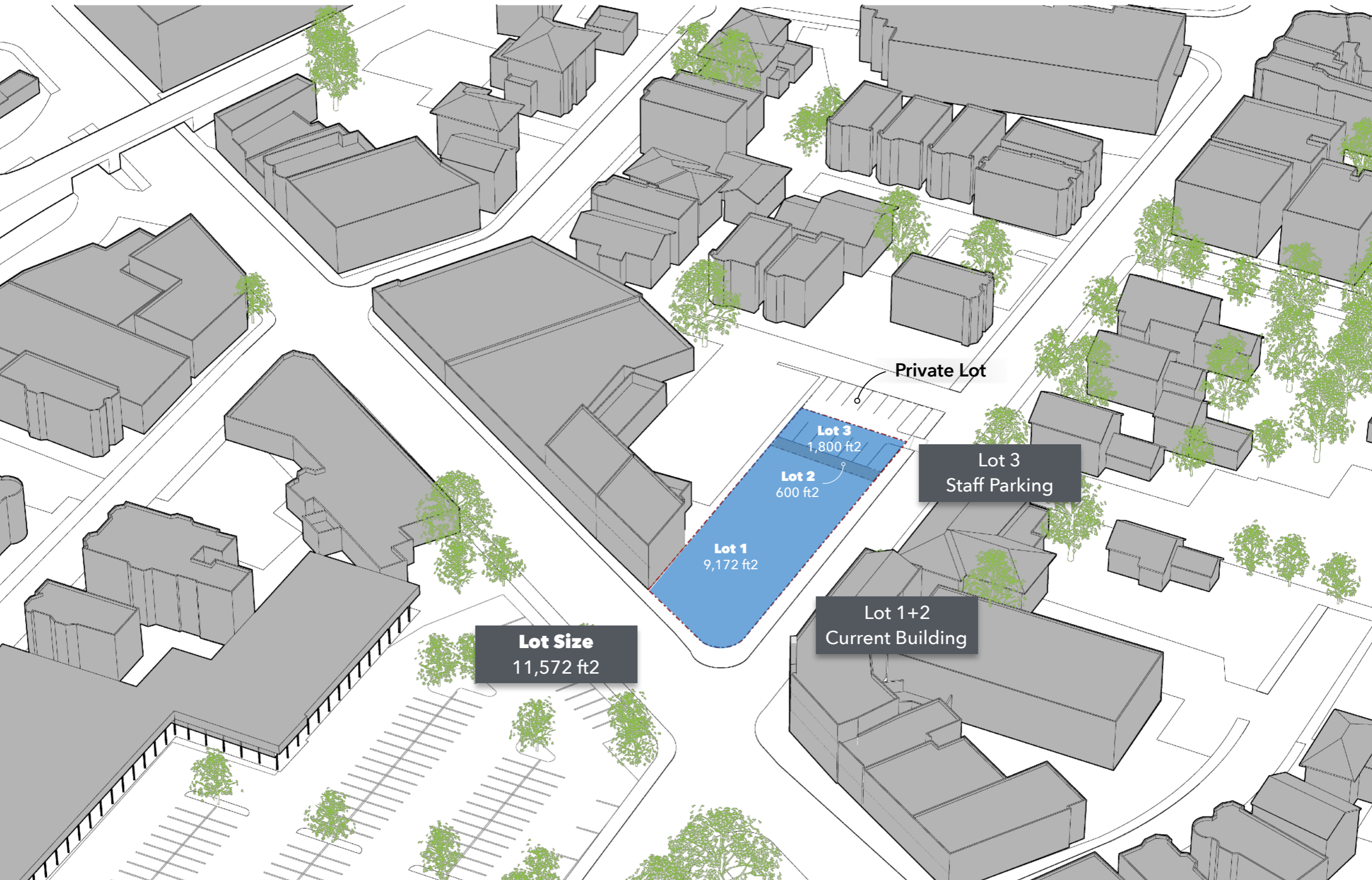

2 Story Branch Library

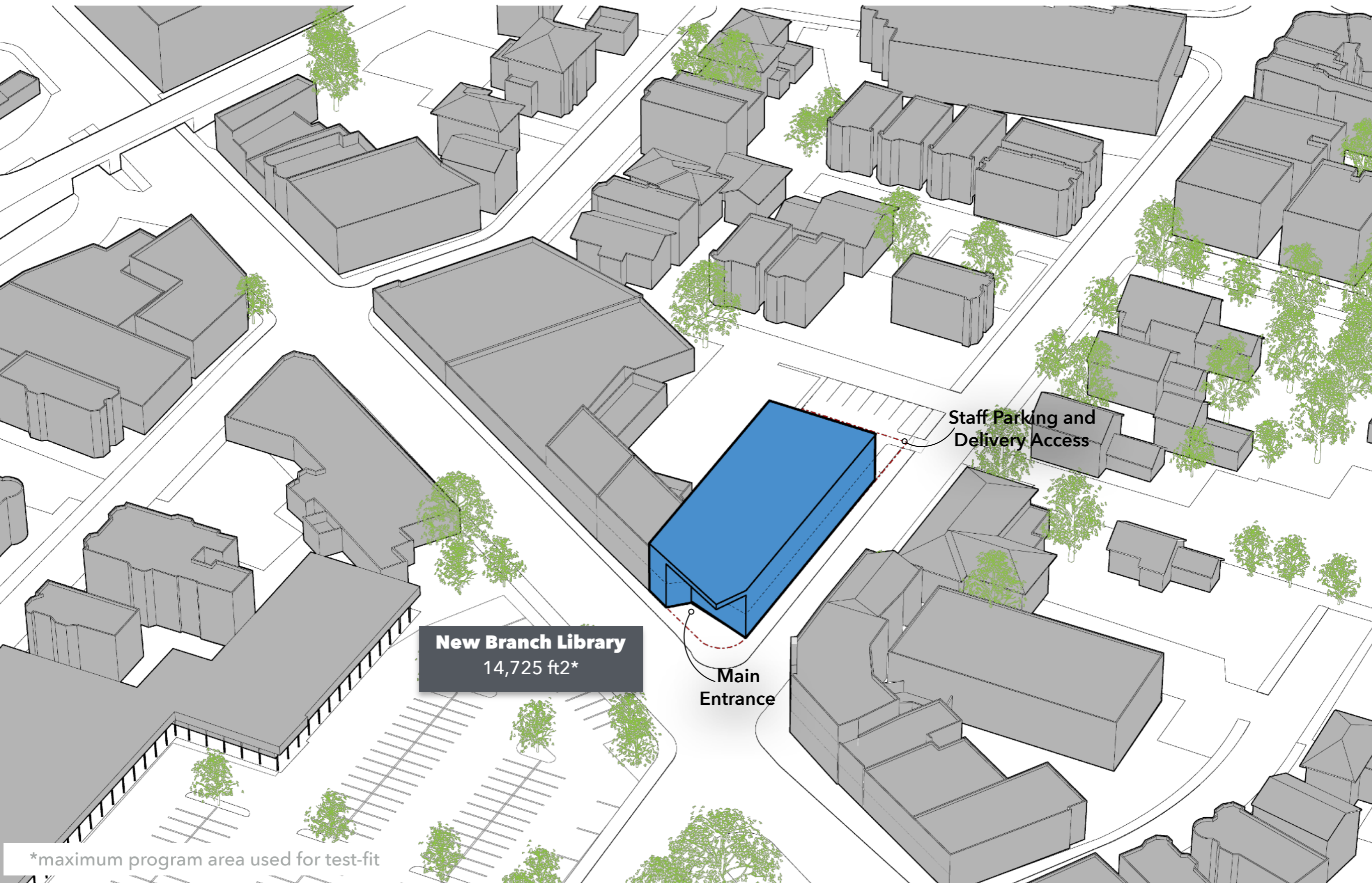

New Branch Library
14,725 ft²*

Staff Parking and
Delivery Access

Main
Entrance

*maximum program area used for test-fit

Mixed-Use Branch Library

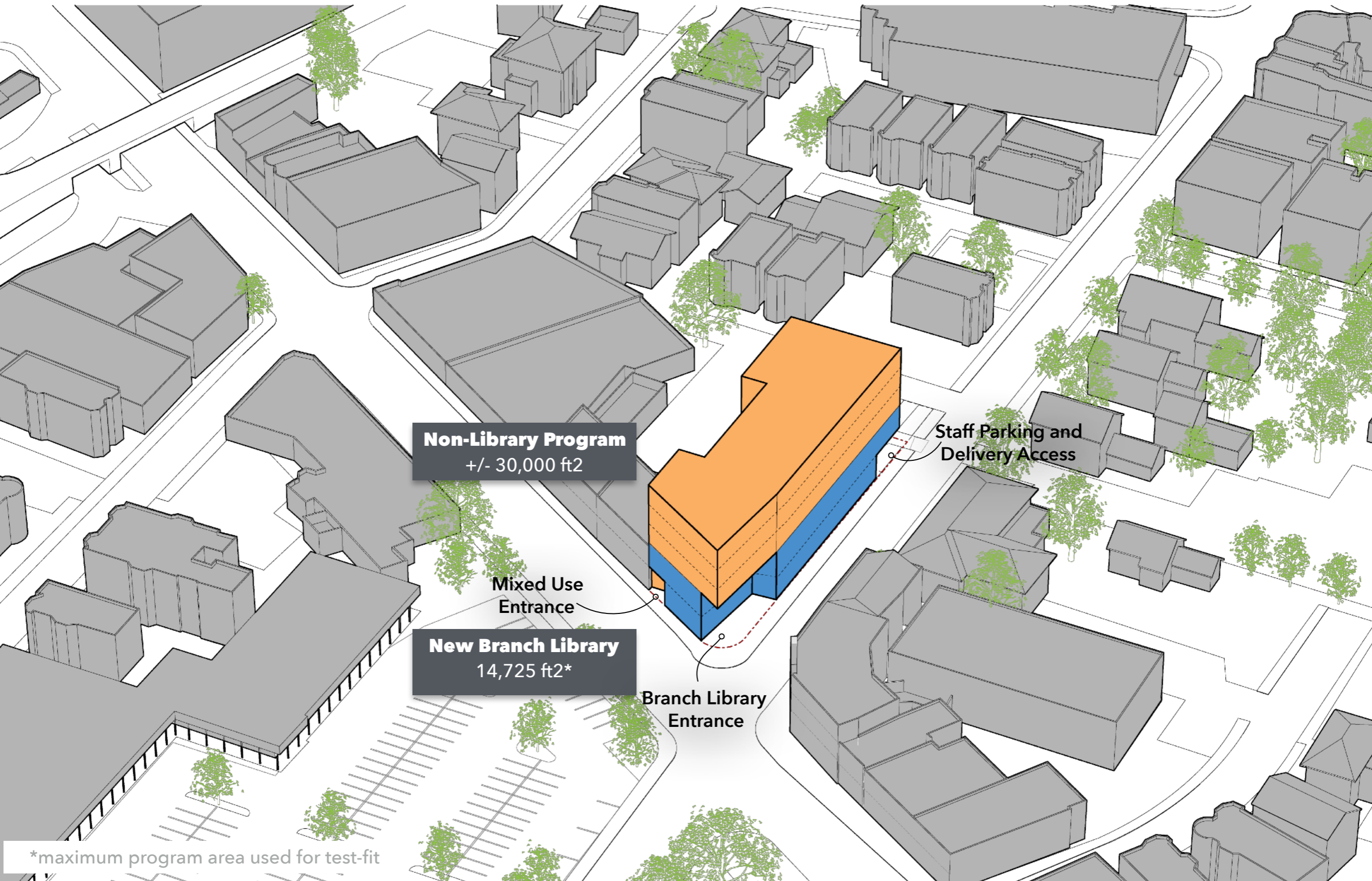

Next Steps

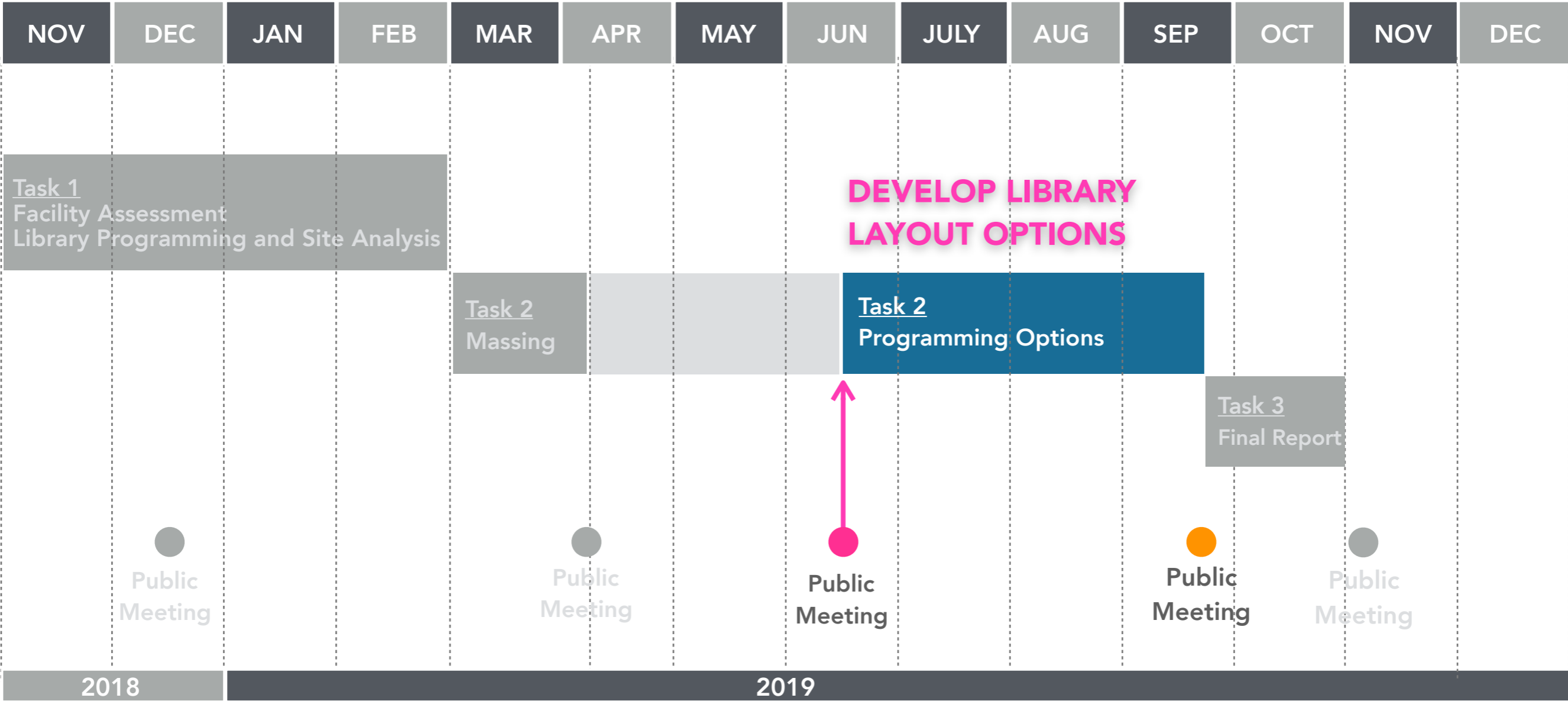

Next Community Meeting in September

Thank You



Feedback?

Please contact:

Priscilla Foley, *Director of Neighborhood Services*

pfoley@bpl.org